

376

Route Guide & Hazard Awareness

*NEWHAM TOWN HALL - PLASHET GROVE - UPTON PARK
WOOLWICH MANOR WAY - BECKTON BUS STATION*



THINGS TO REMEMBER

MAKE NOTES ALONG THE WAY!

CHANGEOVER | BECKTON BUS STATION

Changeovers will take place at Beckton bus station.

Always communicate in advance with iBus if you are late for any reason.

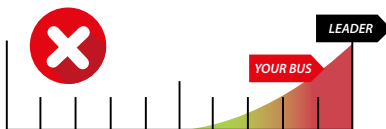

Route 376 is a high frequency route. Headway is a measurement of the distance or time between buses. You can tell that you are on the correct Headway by using the iBus Headway indicator in the cab.

IMPORTANT: You must keep your bus as close to the middle of the indicator as possible. Take action and drop back if you are closing in to the bus in front.

CONTENTS

FULL ROUTE 376 MAP

Between East Ham and Prince Regent Lane.

3

FULL ROUTE 376 MAP

Between Prince Regent Lane and Strait Road.

4

RUNNING LIGHT

To and from East Ham, Newham Town Hall.

5

RUNNING LIGHT

To and from Beckton Bus Station.

6

IN SERVICE

Route guide from Beckton Bus Station to Newham Town Hall.

7

IN SERVICE

Route guide from Newham Town Hall to Beckton Bus Station.

8

EAST HAM, NEWHAM TOWN HALL

Terminus point and map.

9

EAST HAM, WORDSWORTH AVENUE

Curtailment point and map.

10

UPTON PARK, STUKELEY ROAD

Curtailment point and map.

11

UPTON PARK, CLAUGHTON ROAD

Curtailment point and map.

12

NEWHAM GENERAL HOSPITAL

Curtailment point and map.

13

CYPRUS, EAST HAM MANOR WAY

Curtailment point and map.

14

WINSOR PARK ESTATE

Curtailment point and map. Turning point only.

15

BECKTON BUS STATION

Terminus point and map.

16

LOCAL HAZARDS

Hazards to be aware of and other points to note.

17

LOCAL HAZARDS

Hazards to be aware of and other points to note.

18

LOCAL HAZARDS

Hazards to be aware of and other points to note.

19

AT THE GARAGE

General information and safety at the garage.

20

CODES & PROCEDURES

Facility codes, curtailment abrv & emergency radio procedure.

21

THINGS TO REMEMBER

Make notes along the way.

22

ROUTE 376 MAP

EAST HAM AND TOLLGATE ROAD

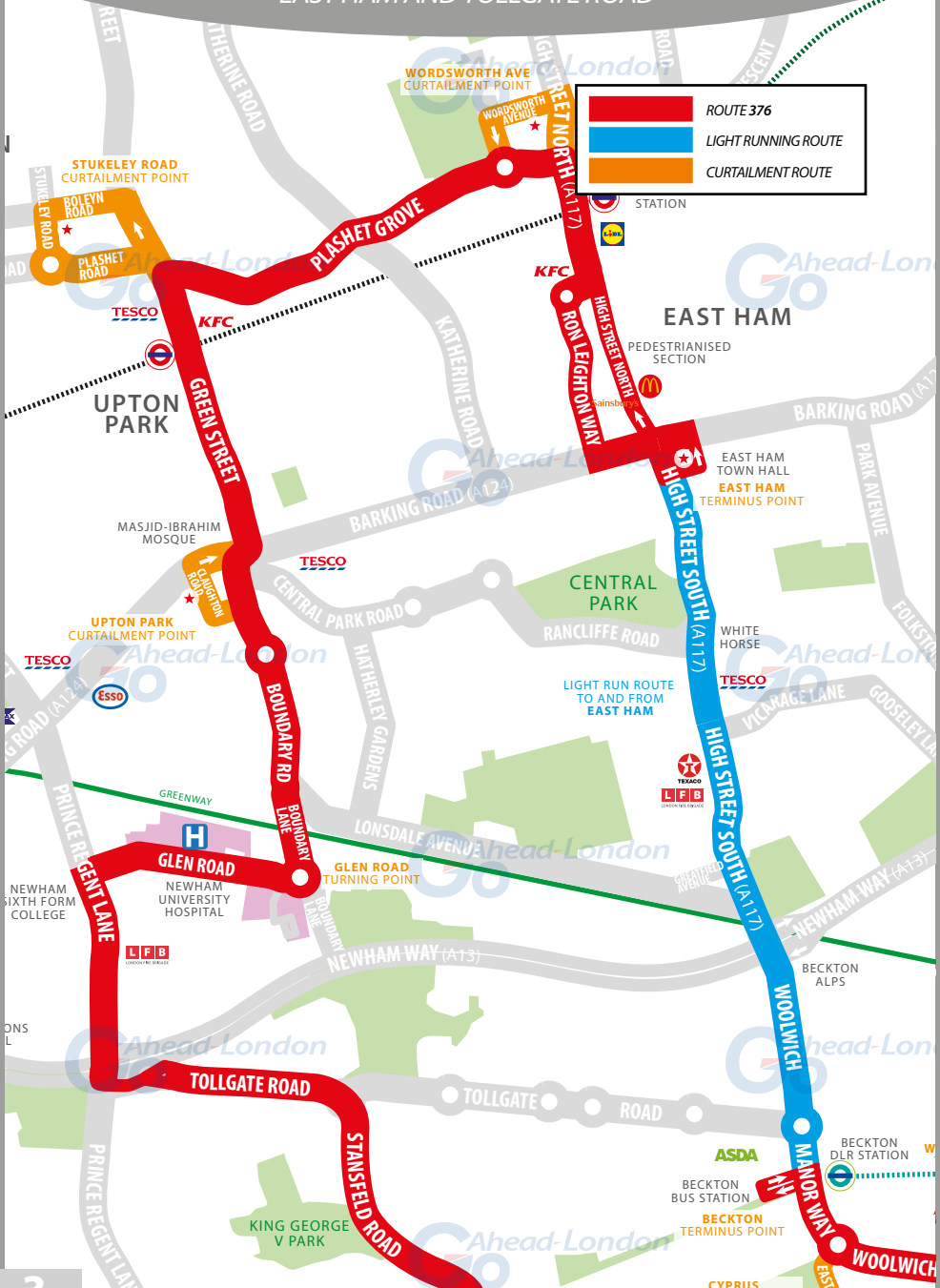

	ROUTE 376
	LIGHT RUNNING ROUTE
	CURTAILMENT ROUTE

STATION

ROUTE 376 MAP

TOLLGATE ROAD AND BECKTON BUS STATION

THIS GUIDE IS DESIGNED TO ASSIST YOU ON ROUTE 376. ENJOY!

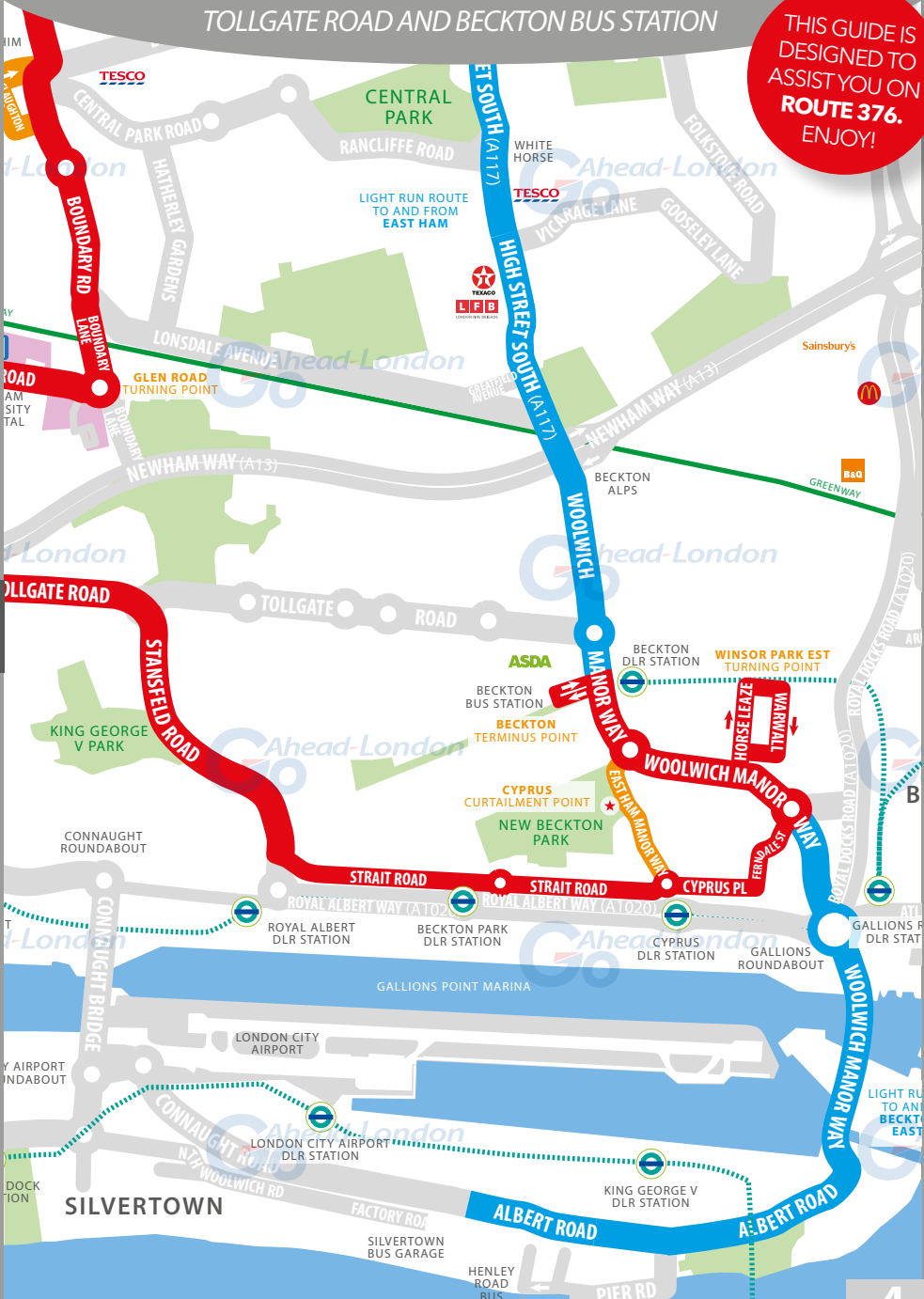

GO TO PAGE 3

RUNNING LIGHT

RUNNING OUT OF SERVICE

IMPORTANT
LOG OFF IBUS
IMMEDIATELY
IF RUNNING
LIGHT

TO EAST HAM NEWHAM TOWN HALL

- From **Silvertown garage**, turn right onto Factory Road
- At junction, turn right onto Albert Road
- At traffic light, continue ahead onto Woolwich Manor Way
- Continue ahead onto Steve Redgrave Bridge
- Continue ahead onto Woolwich Manor Way
- At Gallions Reach roundabout, take 2nd exit onto Woolwich Manor Way **A117**
- At roundabout, take 2nd exit onto Woolwich Manor Way
- At 2nd roundabout, take 2nd exit onto Woolwich Manor Way
- At 3rd roundabout, take 3rd exit onto Woolwich Manor Way (*past Premier Inn*)
- Continue ahead on Woolwich Manor Way (*under Newham Way overpass*) **A117**
- Continue ahead onto High Street South **A117**
- Turn right onto Nelson Street
- Turn left onto Wellington Road to **stand**

FROM EAST HAM NEWHAM TOWN HALL

- From **stand**, continue ahead on Wellington Road
- At junction, turn left onto Barking Road **A124**
- At traffic light, turn left onto High Street South **A117**
- Continue ahead on Woolwich Manor Way (*under Newham Way overpass*) **A117**
- At roundabout, take 2nd exit onto Woolwich Manor Way **A117**
- At 2nd roundabout, take 2nd exit onto Woolwich Manor Way
- At 3rd roundabout, take 2nd exit onto Woolwich Manor Way
- At Gallions Reach roundabout, take 3rd exit onto Woolwich Manor Way
- Continue ahead onto Steve Redgrave Bridge
- At traffic light, continue ahead onto Albert Road
- Turn left onto Factory Road to **Silvertown garage**

RUNNING LIGHT

RUNNING OUT OF SERVICE

IMPORTANT
LOG OFF IBUS
IMMEDIATELY
IF RUNNING
LIGHT

TO BECKTON BUS STATION

- From **Silvertown garage**, turn right onto Factory Road
- At junction, turn right onto Albert Road
- At traffic light, continue ahead onto Woolwich Manor Way
- Continue ahead onto Steve Redgrave Bridge
- Continue ahead onto Woolwich Manor Way
- At Gallions Reach roundabout, take 2nd exit onto Woolwich Manor Way **A117**
- At roundabout, take 2nd exit onto Woolwich Manor Way
- At 2nd roundabout, take 2nd exit onto Woolwich Manor Way
- Turn left into Beckton Bus Station (south side) to **stand**

FROM BECKTON BUS STATION

- From **stand**, exit bus station and turn right onto Woolwich Manor Way
- At roundabout, take 2nd exit onto Woolwich Manor Way
- At 2nd roundabout, take 1st exit onto Woolwich Manor Way
- At Gallions Reach roundabout, take 3rd exit onto Woolwich Manor Way
- Continue ahead onto Steve Redgrave Bridge
- At traffic light, continue ahead onto Albert Road
- Turn left onto Factory Road to **Silvertown garage**

ROUTE DIRECTIONS

RUNNING IN SERVICE

NEVER
DIVERT OFF
LINE-OF-ROUTE
UNLESS ADVISED
BY IBUS

TO EAST HAM NEWHAM TOWN HALL

- From **stand**, exit Beckton Bus Station and turn right onto Woolwich Manor Way
- At roundabout, take 2nd exit onto Woolwich Manor Way
- Turn left onto Horse Leaze
- At junction, turn right onto Newark Knock
- Follow the road to the right onto Warwall
- At junction, turn right onto Covelees Wall
- At junction, turn left onto Horse Leaze
- At junction, turn left onto Woolwich Manor Way
- At roundabout, take 2nd exit onto Ferndale Street
- Follow the road to the right onto Cyprus Place
- At roundabout, take 1st exit onto Strait Road
- Continue ahead past roundabout on Strait Road (*buses only*)
- At junction, turn left onto Stansfield Road
- At Royal Albert Roundabout, take 4th exit back onto Stansfield Road
- At roundabout, take 1st exit onto Tollgate Road
- At traffic light, turn right onto Prince Regent Lane
- At traffic light, turn right onto Glen Road (*past Newham General Hospital*)
- Continue ahead onto Glen Road (*buses and cycles only*)
- At mini-roundabout, exit onto Boundary Lane
- At junction, turn left onto Boundary Road
- At traffic light, turn right onto Barking Road **A124**
- At traffic light, turn left onto Green Street **B167**
- At traffic light, turn right onto Plashet Grove **B165**
- Continue ahead past 3 mini roundabouts on Plashet Grove **B165**
- At traffic light, turn right onto High Street North **A117**
- Follow the road onto Ron Leighton Way
- At roundabout, take 1st exit onto Ron Leighton Way
- At traffic light, turn left onto Barking Road **A124**
- At traffic light, turn right onto High Street South **A117**
- Turn left onto Nelson Street
- Turn left onto Wellington Road to **stand**

ROUTE DIRECTIONS

RUNNING IN SERVICE

IMPORTANT
PLEASE ENSURE
YOU USE YOUR
RIBAS KEY ON
EVERY TRIP

TO BECKTON BUS STATION

- From **stand**, continue ahead on Wellington Road
- At junction, turn left onto Barking Road **A124**
- At traffic light, turn right onto High Street North
- Continue ahead onto High Street North **A117**
- At traffic light, turn left onto Plashet Grove **B165**
- Continue ahead past 3 mini roundabouts on Plashet Grove **B165**
- At traffic light, turn left onto Green Street **B167**
- At traffic light, turn right onto Barking Road **A124**
- Turn left onto Boundary Road
- At roundabout, take 2nd exit onto Boundary Road
- Turn right onto Boundary Lane
- At mini-roundabout, exit onto Glen Road (*buses and cycles only*)
- Continue ahead onto Glen Road (*past Newham General Hospital*)
- At traffic light, turn left onto Prince Regent Lane **A112**
- Continue ahead onto Prince Regent Lane **A112** (*over Newham Way*)
- At traffic light, turn left onto Newham Way/Tollgate Road
- At roundabout, take 2nd exit onto Stansfield Road
- At roundabout, take 1st exit onto Tollgate Road
- Turn left onto Strait Road (*buses only*)
- Continue ahead past roundabout on Strait Road
- At roundabout, take 2nd exit onto Cyprus Place
- Follow the road to the left onto Ferndale Street
- At roundabout, take 1st exit onto Woolwich Manor Way
- Turn right onto Horse Leaze
- At junction, turn right onto Newark Knock
- Follow the road to the right onto Warwall
- At junction, turn right onto Covelees Wall
- At junction, turn left onto Horse Leaze
- At junction, turn right onto Woolwich Manor Way
- At roundabout, take 2nd exit onto Woolwich Manor Way
- Turn left into Beckton Bus Station (south side) to **stand**

EAST HAM

TERMINUS POINT

SWITCH THE
ENGINE OFF
WHILST AT THE
STAND

From Beckton Bus Station. Proceed from High Street South via Nelson Street and Wellington Road to stand.
Set down on High Street South at **BUS STOP V**.

Towards Beckton Bus Station. Depart via Wellington Road to Barking Road.
Pick up on Barking Road at **BUS STOP W**.

Public stand for four buses on west side of Wellington Road.
Blind display: **EAST HAM, NEWHAM TOWN HALL.**

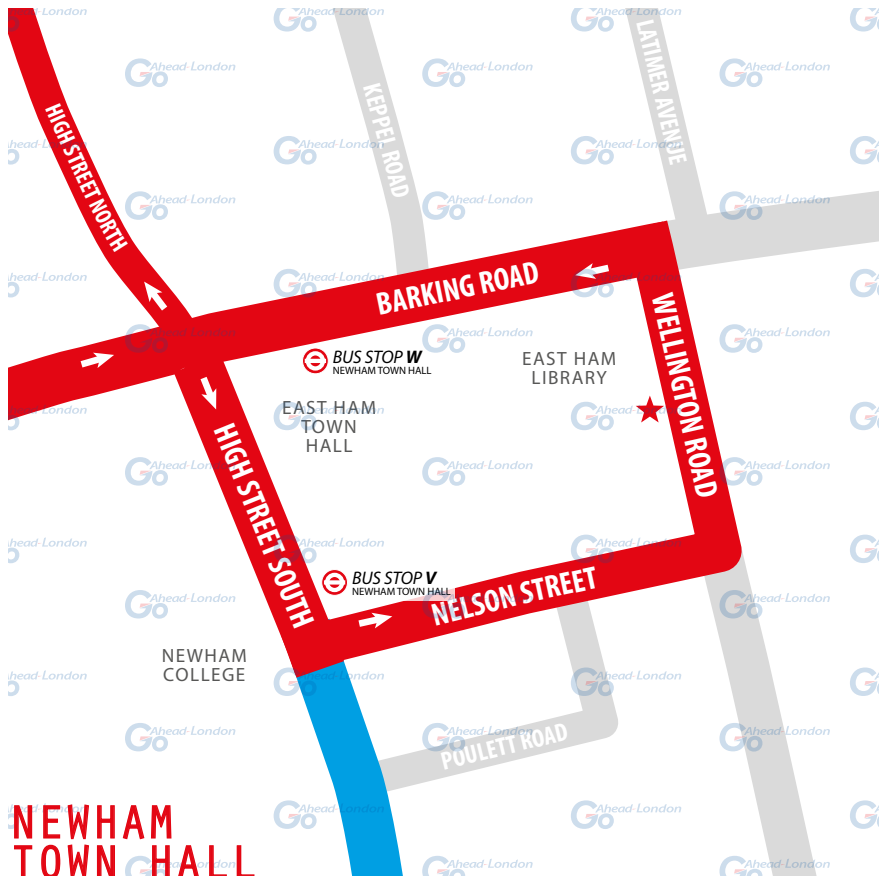

**NEWHAM
TOWN HALL**

EAST HAM

CURTALMENT POINT

PLEASE CHECK
TRIP NUMBER
ON ETM BEFORE
DEPARTING

From Beckton Bus Station. Proceed from Plashet Grove via High Street North and Wordsworth Avenue to stand.
Set down on Plashet Grove South at **BUS STOP E**.

Towards Beckton Bus Station. Depart via Wordsworth Avenue and Woodhouse Grove to Plashet Grove. Pick up on Plashet Grove at **BUS STOP M**.

Public stand for two buses on south side of Wordsworth Avenue. No more than 2 buses on Route 376 should be scheduled to stand at any one time.

Blind display: **EAST HAM, PLASHET GROVE.**



UPTON PARK

CURTAILMENT POINT

PLEASE CHECK
TRIP NUMBER
ON ETM BEFORE
DEPARTING

From Beckton Bus Station. Proceed from Green Street via Neville Road and Stukeley Road to stand. Set down on Green St at **BUS STOP D.**

Towards Beckton Bus Station. Depart via Stukeley Road and Plashet Road to Green Street. Pick up on Green Street at **BUS STOP B.**

Public stand for one bus on the east side of Stukeley Road.

Blind display: **UPTON PARK STATION.**

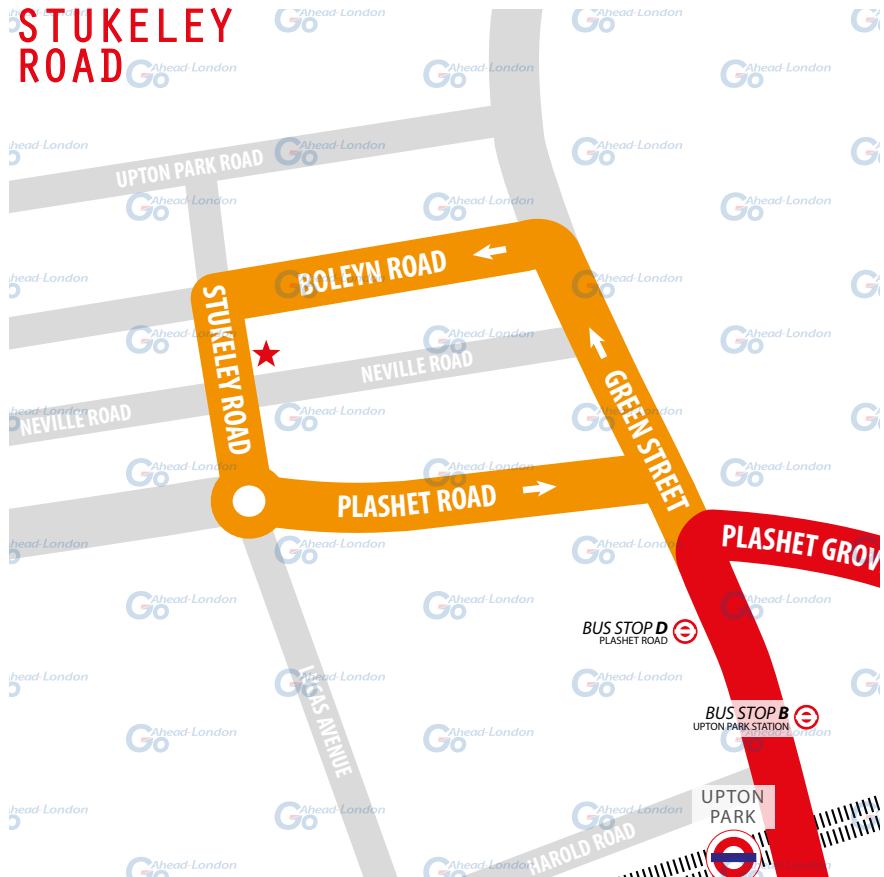

UPTON PARK

CURTALMENT POINT

PLEASE BE
AWARE OF
PEDESTRIANS
AND CYCLISTS

From Beckton Bus Station. Proceed from Boundary Road via Claughton Road to stand. Set down on Boundary Road at **BUS STOP P**.

Towards Beckton Bus Station. Depart via Claughton Road, Barking Road and Central Park Road to Boundary Road.

Pick up on Boundary Road at **BUS STOP BENSON AVENUE**.

From East Ham. Proceed from Green Street via Central Park Road, Boundary Road and Claughton Road to stand. Set down in Green Street at **BUS STOP F**.

Towards East Ham. Depart via Claughton Road and Barking Road to Green Street. Pick up on Green Street at **BUS STOP G**.

Public stand on west side of Claughton Road. **Blind display: UPTON PARK, BOLEYN.**



NEWHAM

CURTAILMENT POINT

PLEASE CHECK
TRIP NUMBER
ON ETM BEFORE
DEPARTING

From Beckton Bus Station. Proceed from Private Road In Newham General Hospital Grounds via Glen Road to stand.
Set down on Glen Road at **BUS STOP HG.**

Towards Beckton Bus Station. Depart via Glen Road, Boundary Lane and Glen Road to Private Road in Newham General Hospital Grounds.
Pick up on Glen Road at **BUS STOP HA.**

Private stand for 3 buses on north side of Glen Road in grounds of Newham General Hospital. **Blind display: NEWHAM HOSPITAL.**



CYPRUS

CURTAILMENT POINT

PLEASE CHECK
TRIP NUMBER
ON ETM BEFORE
DEPARTING

From East Ham. Proceed from Strait Road via East Ham Manor Way to stand. Set down in Strait Road at **BUS STOP S**.

Towards East Ham. Depart via East Ham Manor Way, Woolwich Manor Way and East Ham Manor Way to Strait Road. Pick up on Strait Road at **BUS STOP R**.

Public stand for three buses on west side of East Ham Manor Way.

Blind display: *CYPRUS*.

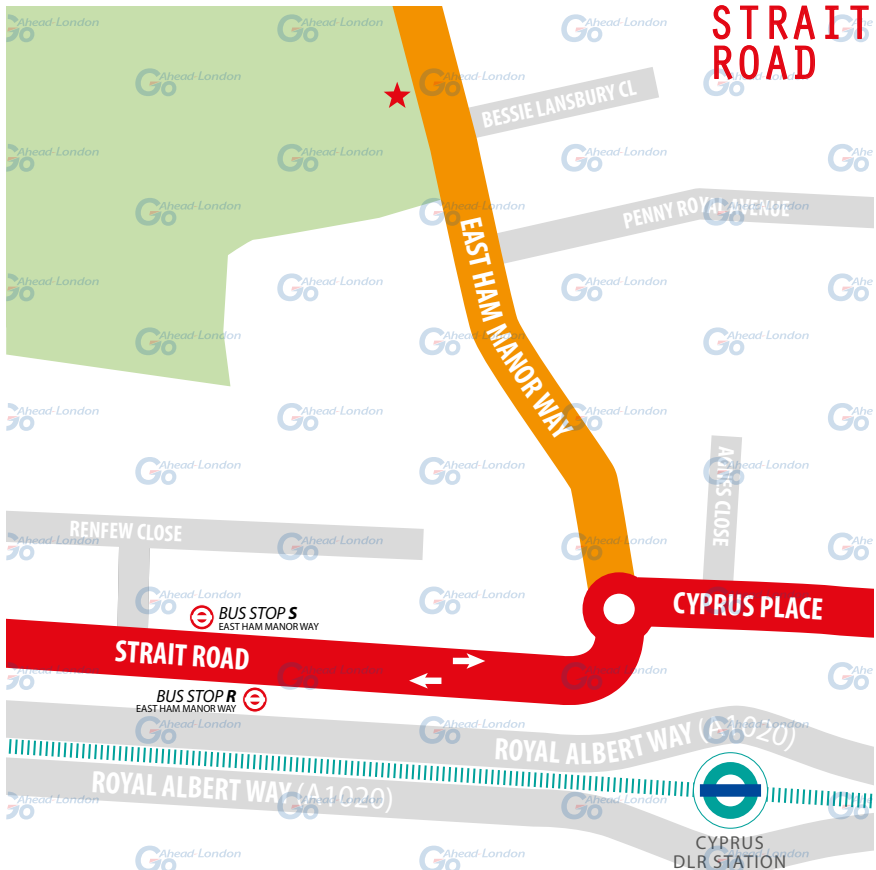

WINSOR PARK ESTATE

TURNING POINT

TURNING POINT ONLY.
BUSES MUST NOT STAND.

From East Ham. Proceed from Woolwich Manor Way via Horse Leaze and Covelees Wall.

Set down on Woolwich Manor Way at **BUS STOP F.**

Towards East Ham. Depart to Warwall.

Pick up on Warwall at **BUS STOP WINSOR PARK ESTATE.**

Turning point only - buses must not stand.

Blind display: **WINSOR PARK**

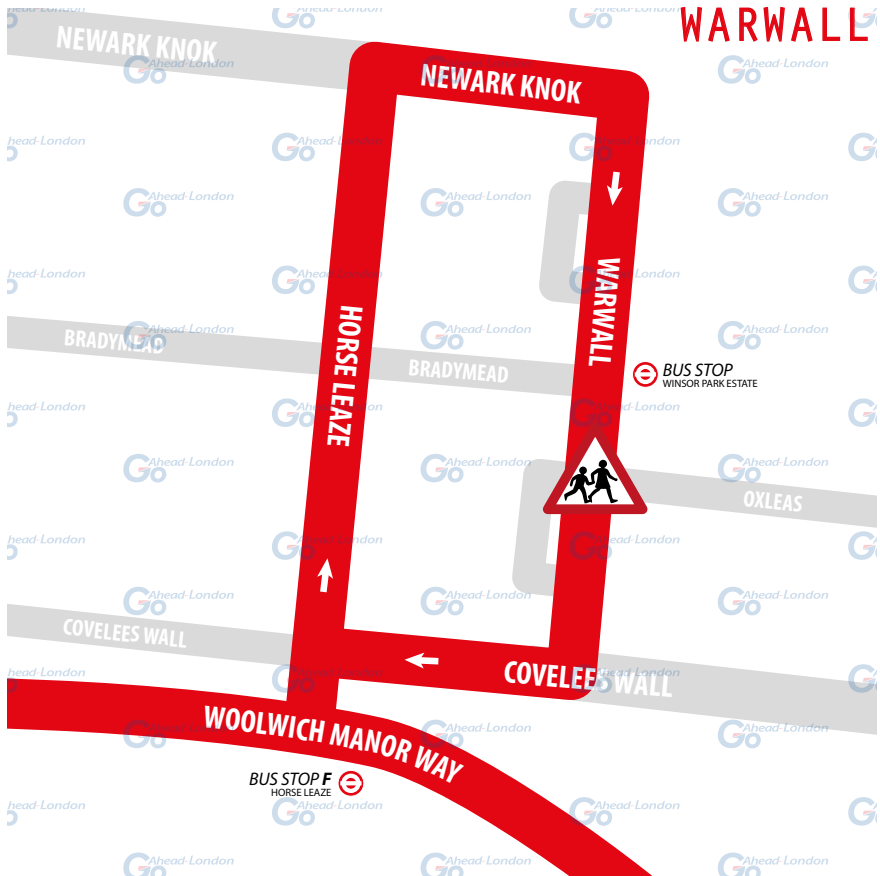

BECKTON BUS STATION

TERMINUS POINT

PLEASE CHECK
TRIP NUMBER
ON ETM BEFORE
DEPARTING

From East Ham. Proceed from Beckton Bus Station direct to stand. Set down on Beckton Bus Station at **BUS STOP A**.

Towards East Ham. Depart to Beckton Bus Station.
Pick up on Beckton Bus Station at **BUS STOP B**.

Private stand for four buses on Routes 366 and 376 in 2 portions on south side of bus station on west side of Woolwich Manor Way.

Blind display: **BECKTON STATION**.

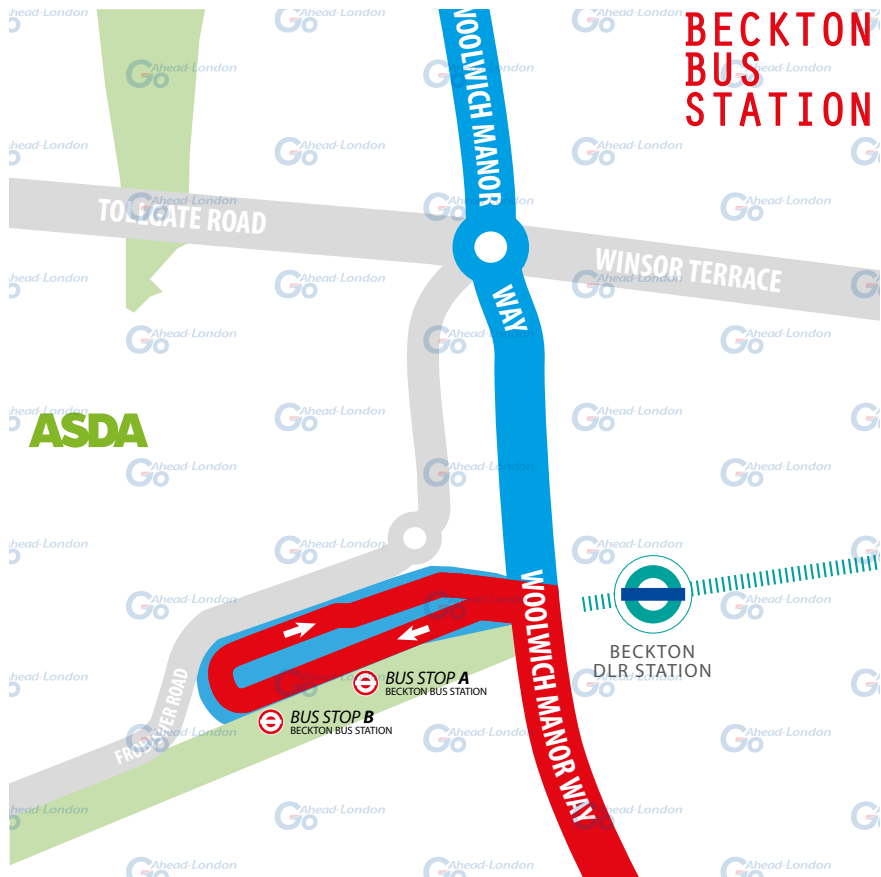

LOCAL HAZARDS & POINTS TO NOTE

SEE RISK ASSESSMENT VIEWABLE UPON REQUEST



PARKED VEHICLES | EAST HAM, NELSON ROAD

Parked vehicles on both sides of the road. Drivers to take care and caution and use appropriate speed.

BUSY PEDESTRIAN AREA | TOWN HALL BARKING ROAD

Very busy area with pedestrians crossing between parked vehicles often without looking. Drivers advised to exercise care and caution and to report any near misses.

BUSY BUS STOPS | HIGH STREET NORTH

Drivers are required to wait for intending passengers. When closing the doors, ensure it is clear.

BUSY PEDESTRIAN AREA | HIGH STREET NORTH

Very busy area with pedestrians crossing between parked vehicles often without looking. Drivers advised to exercise care and caution and to report any near misses.

VERY NARROW ROAD | PLASHET GROVE EAST HAM

Very narrow road with cars often parked on either side. Risk of collision with oncoming vehicles if driver fails to plan ahead. Additionally, there is a primary school, mosque and registry office. Drivers advised to take care and caution and are required to plan ahead. Only proceed if it is safe to do so.

MINI ROUNDABOUTS | PLASHET GROVE EAST HAM

Mini roundabouts may lead to discomfort, injury or damage to bus if taken at speed. Drivers advised to reduce speed and to exercise care when passing.

PEDESTRIAN AREA | PLASHET GROVE UPTON PARK

Very busy area with pedestrians crossing between parked vehicles often without looking. Drivers advised to exercise care and caution and to report any near misses.

BUSY PEDESTRIAN AREA | GREEN STREET

Very busy area with pedestrians crossing between parked vehicles often without looking. Drivers advised to exercise care and caution and to report any near misses.

LOCAL HAZARDS & POINTS TO NOTE

SEE RISK ASSESSMENT VIEWABLE UPON REQUEST



VERY NARROW ROAD | BOUNDARY ROAD

Very narrow road with cars often parked on either side. Risk of collision with oncoming vehicles if driver fails to plan ahead. Additionally, there is a primary school, mosque and registry office. Drivers advised to take care and caution and are required to plan ahead. Only proceed if it is safe to do so.

BARRIER | NEWHAM GENERAL HOSPITAL/GLEN ROAD

No through road for general traffic, only London Buses. Nearside blocked by barrier which is not in use. Drivers advised to exercise care and caution when passing the barriers on the offside lane. Be aware of other vehicles.

POTHOLES | GLEN ROAD

Potholes may lead to discomfort, injury or damage to bus if taken at speed. Drivers advised to reduce speed and to exercise care and caution when passing.

SHARP LEFT TURN | PRINCE REGENT LANE/GLEN ROAD

Sharp left turn out of Glen Road onto Prince Regent Lane. Risk of collision/damage if bus is not positioned correctly. Drivers advised to exercise caution when passing and to keep checking mirrors.

BUSY BUS STOPS | PRINCE REGENT LANE

Drivers are required to wait for intending passengers. When closing the doors, ensure it is clear.

UNEVEN ROAD SURFACE | STANSFIELD ROAD

Uneven road surface may lead to discomfort, injury to passengers or damage to bus if taken at speed. London City Farm in the area. Drivers advised to plan ahead and approach with caution. Drivers must take extra care and allow plenty of room when passing and do not accelerate too fast when passing horses.

RISK OF COLLISION | STRAIT ROAD

Uneven road surface may lead to discomfort, injury to passengers or damage to bus if taken at speed. Drivers advised to exercise care and caution when passing.

LOCAL HAZARDS & POINTS TO NOTE

SEE RISK ASSESSMENT VIEWABLE UPON REQUEST



TIGHT RIGHT TURN | WINSOR PARK ESTATE

Very narrow road with sharp right turns and blind bends. Risk of collision if driver fails to read the road ahead. Approach junctions and bend with caution. Speed humps have been added. Drivers advised to exercise care and caution when turning and approaching bends and give way when possible. Drivers must adhere to the speed limit.

BUSY BUS STOPS | BECKTON BUS STATION

Drivers are required to wait for intending passengers. When closing the doors, ensure it is clear.

BUSY BUS STOPS | BECKTON BUS STATION

Offside parking on stand. Risk of bus passing if you step off the bus or if you drive past a bus driver when they are stepping off. Approach parked buses with caution and look before stepping off the bus.



WARWALL

SCHOOL CHILDREN CROSSING

North of Covelees Wall in Winsor Park Estate

AT THE GARAGE

GARAGE AND GENERAL SAFETY INFORMATION

BE VISIBLE
**WEAR YOUR
HI-VIS** WITHIN
THE GARAGE

GO SLOW!
MANDATORY
SPEED OF 5 MPH
WITHIN THE
GARAGE

BE NOTICED
HEADLIGHTS
ON AT ALL TIMES
IN THE GARAGE

STICK TO
DESIGNATED
PATHS AND
WALKWAYS

NO EXCUSES
PLEASE ABIDE BY
THE RULES. IT'S
MANDATORY!

BE AWARE.
REPORT ALL
HAZARDS
IMMEDIATELY

REMEMBER
**LOOK OUT
FOR CYCLISTS**
DRIVE SLOWLY

PARK FERRY
VEHICLES WITHIN
DESIGNATED
AREAS

**USE THE
HORN** WHEN
APPROACHING
CORNERS &
REVERSING

HYBRID BUSES
ARE SILENT. BE
EXTRA CAUTIOUS
WHILST ON THE
MOVE!

FUEL, OIL &
COOLANT SPILLS
CAN MAKE THE
SURFACE SLIPPERY
BE AWARE

FAMILIARISE
YOURSELF WITH
THE GARAGE
SAFETY CODE

THINK FIRST AND



OTHER INFORMATION

CODES AND EMERGENCY RADIO PROCEDURES

REMAIN CALM:
GIVE ACCURATE
INFORMATION.
WE'RE HERE
TO ASSIST!

ROUTE 376 | CURTAILMENT ABBREVIATIONS

BEC	Beckton Bus Station	WPE	Winsor Park Estate
EHV	Cyprus, East Ham Manor Way	NGH	Newham General Hospital
UCRD	Upton Park, Cloughton Road	USRD	Upton Park, Stukeley Rd
EHWA	East Ham, Wordsworth Avenue	EHTH	Newham Town Hall

FACILITIES | THROUGHOUT THE ROUTE

- **Beckton Bus Station.** TfL facilities available in the bus station. If you urgently need to use a facility, please inform iBus immediately.

CODE RED | EMERGENCY RADIO PROCEDURE

If you require the Emergency Services to attend your vehicle (for example in the event of passenger injury, assault or major RTA), contact CentreComm using the radio's Code Red facility. To call CentreComm, **hold down the Code Red button on your vehicle's radio for at least 3 seconds** until you hear a ringing tone to indicate that your call has been connected. Hold down the foot switch in the cab when you are speaking, and end what you have to say with the word "over" to indicate that you expect a response. Release the foot switch when you are not speaking. Remember to speak slowly and clearly. You will usually receive a radio call from your depot shortly after you make a Code Red call. **You should not use the radio whilst the vehicle is in motion.**

CODE
GREEN

Call your garage for non-emergency, mechanical defects, help or advice

CODE
BLUE

Call CentreComm for non-emergency, incident reporting or diversions

CODE
RED

Call CentreComm for emergency services, passenger injury or assault